

Plates, shed method

System ATS - 119.1

ACM (Aluminium Composite Material),
HPL, Fibre cement

Product changes in the sense of a technical progress are reserved. All advice recommendation and information is given to the best of our knowledge but without any obligation on our part. 03/2010

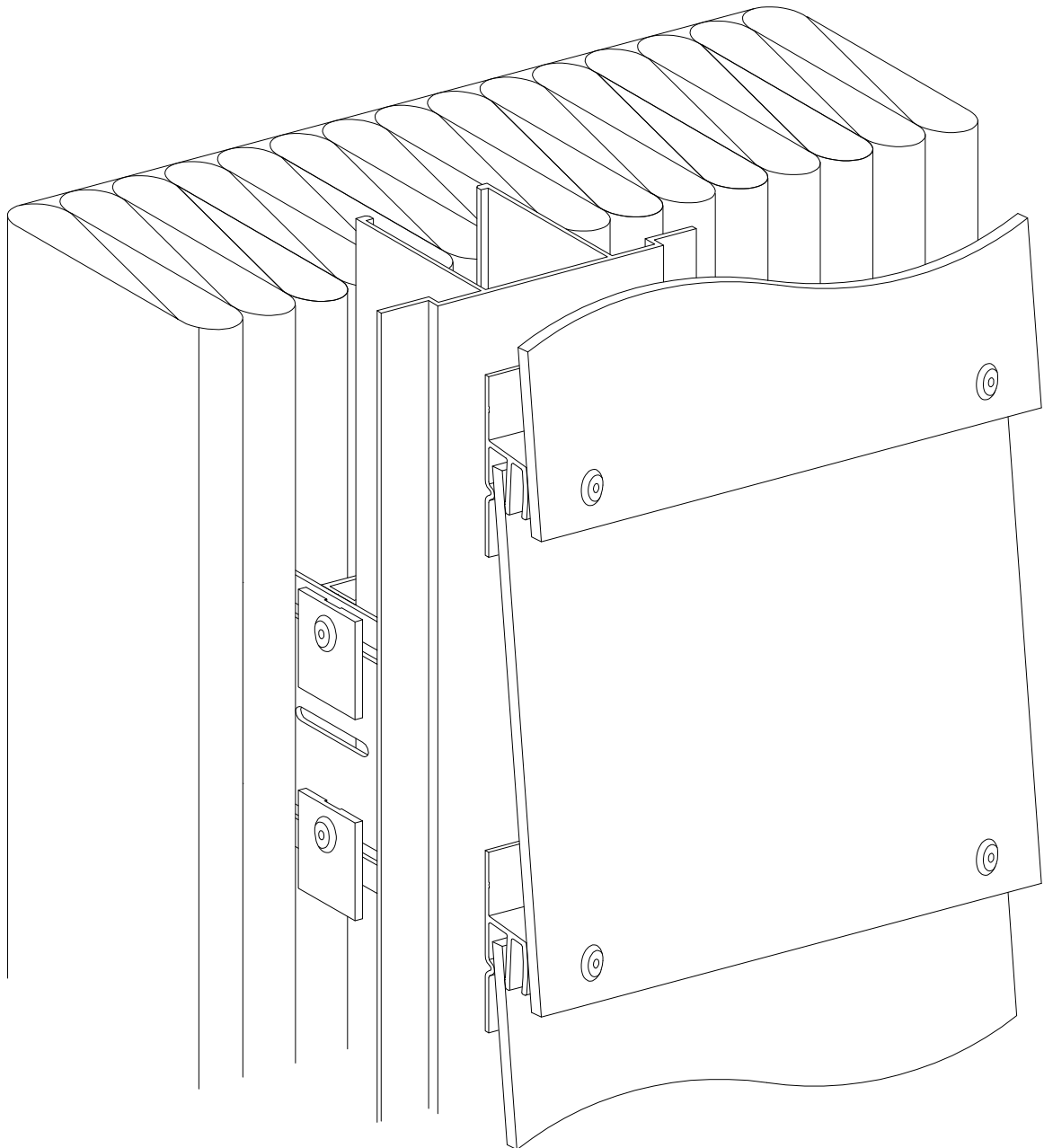

Plates, shed method

ACM (Aluminium Composite Material),
HPL, Fibre cement

System ATS - 119.1

Installation scheme

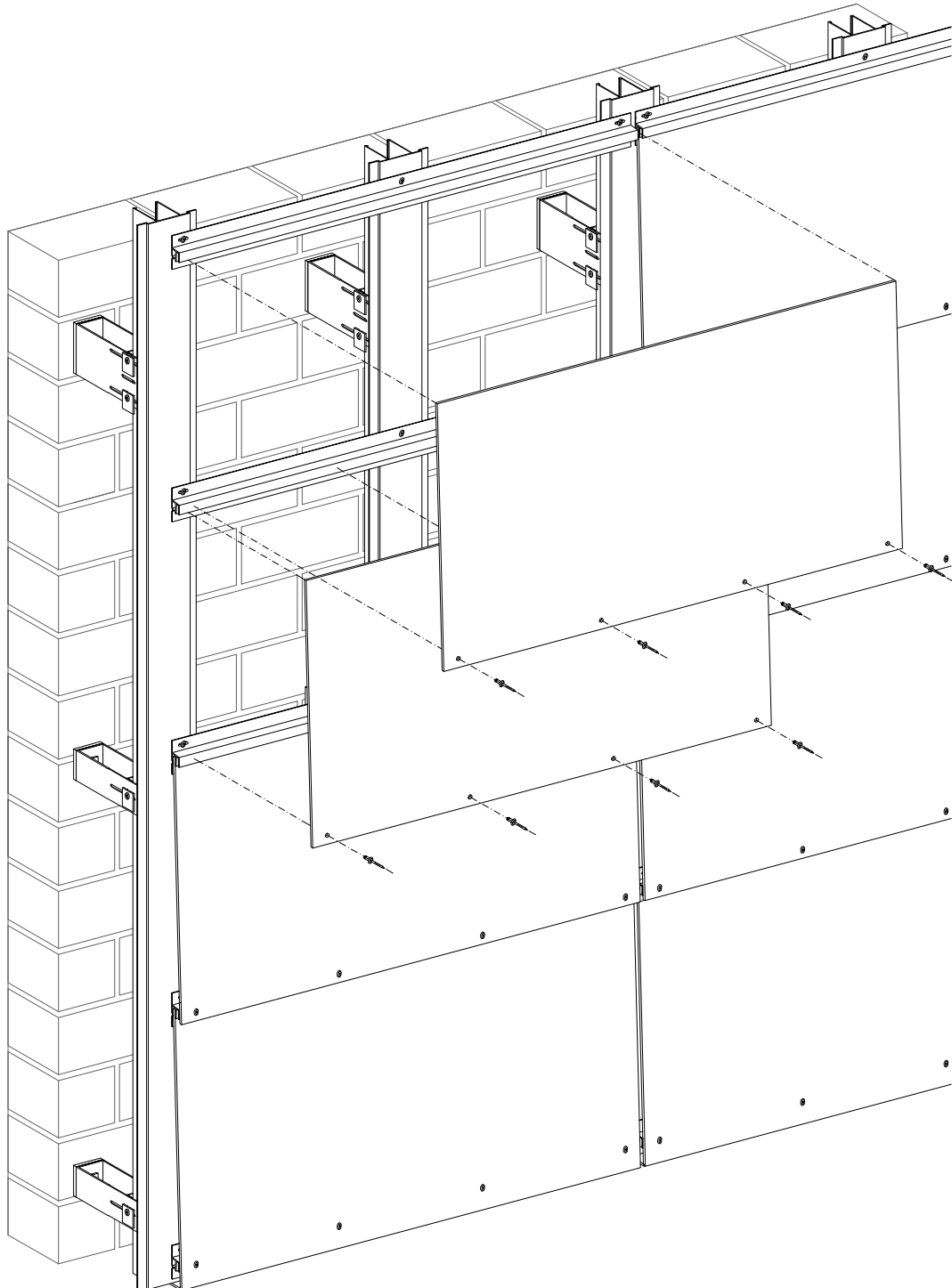

Product changes in the sense of a technical progress are reserved. All advice recommendation and information is given to the best of our knowledge but without any obligation on our part. 03/2010